

Existing Trees to Remain:

1. *Conocarpus erectus* var., Silver Buttonwood, 8" DBH, 12' HT, 12' SPR, Condition: Fair

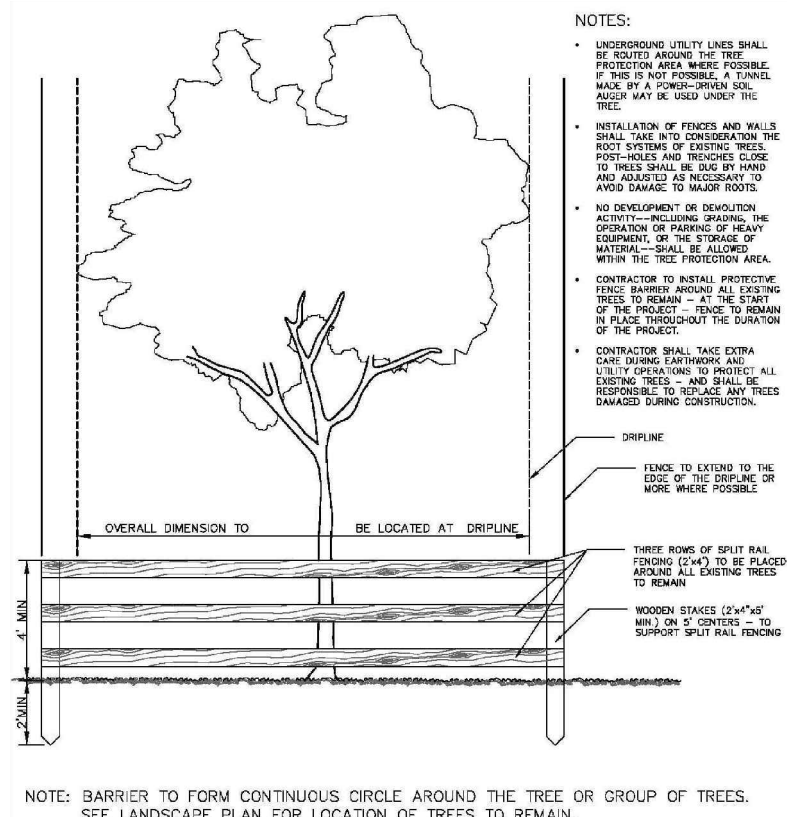

TREE PROTECTION DETAIL
NOT TO SCALE

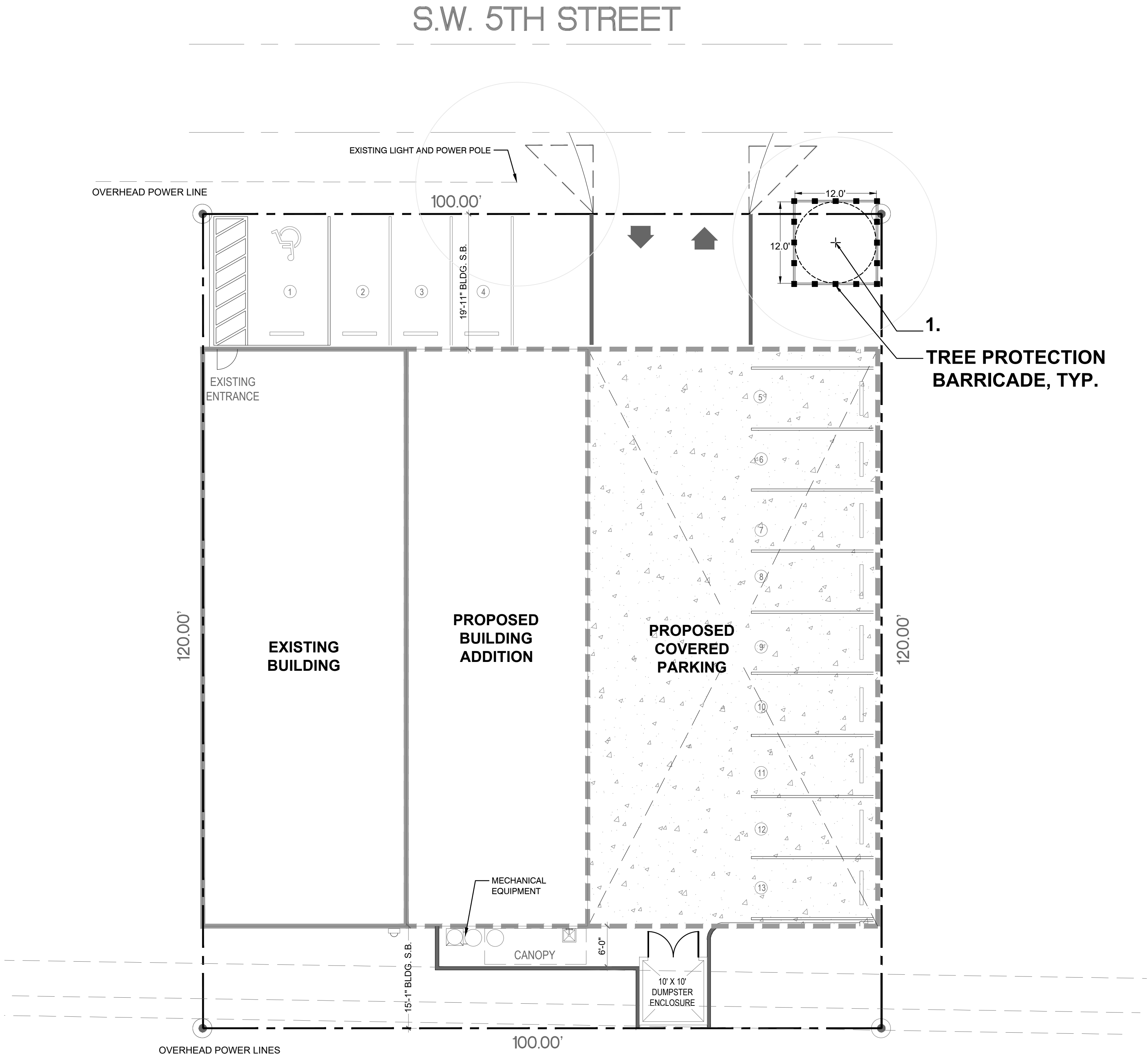

Project Team

Landscape Architect:

LAS

LANDSCAPE
ARCHITECTURAL
SERVICES, LLC

Brandon White | Owner
772-834-1357 | brandon@las-fl.com
Paul Goulas | Owner
772-631-8400 | paul@las-fl.com
1708 SE Joy Haven Street
Port St. Lucie, FL 34983

Architect:

RAMOS ARCHITECTS & ASSOC.
790 Tamiami Canal Road
Miami, FL 33144
(305) 506-7388

Proposed Building Addition & Parking For:

50 S.W. 5th Street Pompano Beach, FL 33060

Existing Tree Information

Revisions		
Date	Init.	Description
04.23.25	DC	Initial Submittal

REGISTERED LANDSCAPE ARCHITECT
PAUL A. GOULAS
LA 6666807
STATE OF
FLORIDA
PAUL GOULAS, RLA
FLORIDA REG. # LA6666807

Drawn By: DC

Checked By: BW

Municipal Project:

Scale:

NORTH

SCALE: 1" = 10'

0' 5' 10' 20'

LS-2

DRC